

The information contained in this drawing is the sole property of Coil Winding Specialist Inc (CWS). Any reproduction in part or whole without written permission of CWS is prohibited.

## F-50A-77C

### Features

MnZn ferrite material with range up to 100 kHz for wide range of high and low flux density inductive designs.

Burnished to break sharp edges, can contain Parylene C coat at smaller diameters from the length of 9.5mm (0.375") or a uniform coating of thermo-set plastic at larger dimensions (if part numbers ends with a C).

REVISION HISTORY					
REV	ECN	DESCRIPTION	SIGN & DATE		
			BY	DATE	AP. DATE
A		Production release	EO	1/31/13	JL 1/31/13

Electrical Specifications				
Item	Unit/Symbol	Condition	Value	Tol.
A <sub>L</sub>	nH/N <sup>2</sup>	@ 10 KHz	1300	± 25%
L <sub>c</sub>	cm	N/A	2.95	± 10%
A <sub>e</sub>	cm <sup>2</sup>	N/A	0.150	± 10%
V <sub>e</sub>	cm <sup>3</sup>	N/A	0.47	± 10%
Initial Permeability	μ <sub>0</sub>	@ B < 10 gauss	2000	± 20%
Temp. Coeff. Of initial Permeability	%, °C	20 - 70 °C	0.7	Typ.
Coercive Force	H <sub>c</sub>	oersted	0.30	Typ.
Residual Flux Density	Gauss, B <sub>r</sub>	N/A	1800	Typ.
Flux Density	Gauss, B	Initial (B), oersted	4900	Typ.
	Gauss, H	@ Field Strength (H), oersted	5	Typ.
Curie temperature	°C	T <sub>c</sub>	> 200	Nom.
Resistivity	Ω cm, ρ	@ Field Strength	10 <sup>2</sup>	Typ.
Loss Factor	10 <sup>-6</sup> , tanδ / μ	Initial	15	Typ.
	MHz	@ Frequency	0.1	Typ.

Dimensional Tolerances				
	in	tol.	mm	tol.
Case				
B (Outer Diameter)	0.529	Max	13.45	Max
A (Inner Diameter)	0.284	Min	7.20	Min
H (Height)	0.279	Max	7.10	Max
Weight	2.40 g			

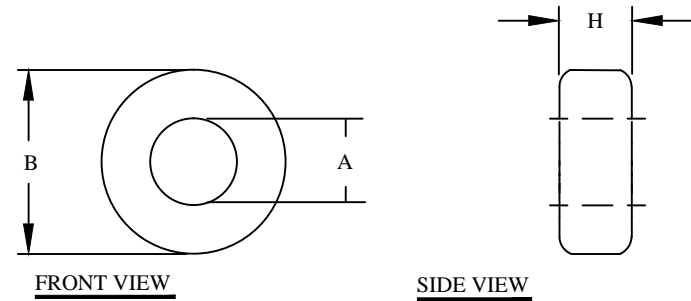

**For additional detail, specifications and charts see:**

[http://www.bytemark.com/products/ferrite\\_matl.htm](http://www.bytemark.com/products/ferrite_matl.htm)

CODE IDENT	MFG. P/N	DESCRIPTION	ITEM NO.
<b>PARTS LIST</b>			
AUTOCAD	X	www.coilws.com www.cwsbytemark.com	CWSBYTEMARK 353 West Grove Ave. Orange, CA. 92865
SOLIDWORKS			
DRAWN	EO 1/31/13	<b>TITLE:</b> <b>Ferrite Toroid Core Material</b> <b>77, MnZn, Plastic Coated</b>	
CHECKED	JL 1/31/13		
ENGR.	JL 1/31/13		
APPR.	JL 1/31/13	<b>SIZE DWG. NO.</b> <b>B F-50A-77C</b>	<b>REV</b> <b>A</b>
<small>UNLESS OTHERWISE SPECIFIED</small> <small>DIMENSIONING AND TOLERANCE PER ANSI Y14.5M</small> <small>ALL DIMENSIONS ARE IN INCHES AND [MILLIMETERS].</small> <small>TOLERANCE INCHES: .XXX=±.005 .XX=±.015 &lt;math&gt;\phi&lt;/math&gt;=±0'30'</small> <small>TOLERANCE METRICS: .XXX=±.127 .XX=±.38 &lt;math&gt;\phi&lt;/math&gt;=±0'30'</small> <small>ANGLE PROJECTION</small>		<b>SCALE</b> <b>N/A</b>	<b>SHEET</b> 1 <b>OF</b> 1
DO NOT SCALE DRAWING			