

The information contained in this drawing is the sole property of Coil Winding Specialist Inc (CWS). Any reproduction in part or whole without written permission of CWS is prohibited.

T50-8 or T50-8/90

Features

Low core loss and good results of linearity through high bias administration.
Applicable (at ≥50kHz) for Power Factor Correction Chokes, DC Chokes and higher Et/N.

REVISION HISTORY					
REV	ECN	DESCRIPTION	SIGN & DATE		
			BY	DATE	AP. DATE
A		Production release	EO	3/7/13	JL 3/7/13

Electrical Specifications				
Item	Unit/Symbol	Condition	Value	Tol.
A _L	nH/N ²	AC flux density of 10 gauss (1 mT) @ 10 kHz	17.5	± 10%
L _e	cm	N/A	3.19	Typ.
A _e	cm ²	N/A	0.112	Typ.
V _e	cm ³	N/A	0.358	Typ.
Density	g/cm ³	N/A	6.5	Typ.
Permeability	μ ₀	N/A	35	± 10%
Permeability with DC BIAS	%μ ₀ , μ ₀ effective	HDC = 50 Oersted	91, 31.9	Typ.
Temp. Coef. of Permeability	+ppm/°C	N/A	255	Typ.
Coef. of Lin. Expansion	+ppm/°C	N/A	10	Typ.
Thermal Conductivity	mW/cm-°C	N/A	29	Typ.

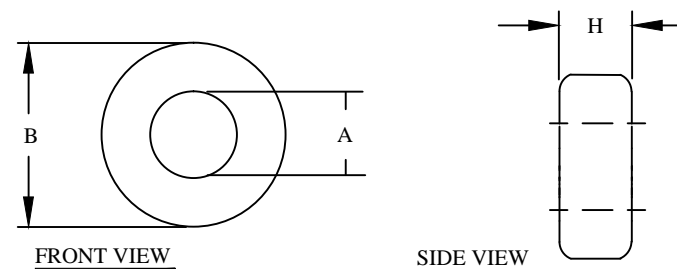

Case Dimensional Tolerances				
	in	tol.	mm	tol.
B (Outer Diameter)	0.500	0.020	12.70	0.51
A (Inner Diameter)	0.303	0.020	7.70	0.51
H (Height)	0.190	0.020	4.83	0.51
Weight 2.33 g				

$$\text{Temperature Rise } \Delta T(^{\circ}\text{C}) = \left[\frac{\text{Total Power Dissipation (milliwatts)}}{\text{Surface Area (cm}^2\text{)}} \right]^{0.833}$$

$$\text{Required turns} = \left[\frac{\text{desired L (nH)}}{A_L \left(\frac{\text{nH}}{\text{N}^2} \right)} \right]^{\frac{1}{2}}$$

$$\text{Peak AC Flux Density: } B_{pk} = \frac{E_{avg} 10^8}{4ANf}$$

$$\text{Magnetizing Force: } H = \frac{0.4\pi NI}{\ell}$$

- L = inductance
- nH = nanohenries
- H = oersteds (Oe)
- N = Number of turns
- I = Current (amperes)
- ℓ = Mean Magnetic Path (cm)
- A = Cross-sectional area (cm²)
- f = frequency (hertz)
- B_{pk} = Gauss (G)

For additional detail, specifications and charts see:

http://www.bytemark.com/products/IPCores_index.html

Core Loss in mW/cm ³ (extrapolated data from high frequency testing)						
Frequency	60 Hz	1kHz	10kHz	50kHz	100kHz	500kHz
Condition	@ 5000G	@ 1500G	@ 500G	@ 225G	@ 140G	@ 50G
Value	45	64	59	50	35	28

UNLESS OTHERWISE SPECIFIED
DIMENSIONING AND TOLERANCE PER ANSI Y14.5M
ALL DIMENSIONS ARE IN INCHES AND [MILLIMETERS].
TOLERANCE INCHES: .XXX=±.005 .XX=±.015 \angle=±0°30'
TOLERANCE METRICS: .XXX=±.127 .XX=±.38 \angle=±0°30'
ANGLE PROJECTION
DO NOT SCALE DRAWING

CODE IDENT	MFG. P/N	DESCRIPTION	ITEM NO.
PARTS LIST			
AUTOCAD	X	www.coilws.com www.cwsbytemark.com	CWSBYTEMARK 353 West Grove Ave. Orange, CA. 92865
SOLIDWORKS			
SIGN	DATE		
DRAWN	EO 3/7/13		
CHECKED	JL 3/7/13	TITLE: Iron Powder Core Material Mix 8 or 8/90, Yellow/Red	
ENGR.	JL 3/7/13	SIZE DWG. NO. B T50-8 or T50-8/90 REV A	
APPR.	JL 3/7/13	SCALE N/A SHEET 1 OF 1	