

The information contained in this drawing is the sole property of Coil Winding Specialist Inc (CWS). Any reproduction in part or whole without written permission of CWS is prohibited.

F-50A-75

Features

MnZn ferrite material with high permeability for broadband and pulse transformers applications. Also intended for common-mode inductor designs.

Burnished to break sharp edges, can contain Parylene C coat at smaller diameters from the length of 9.5mm (0.375") or a uniform coating of thermo-set plastic at larger dimensions (if part numbers ends with a C).

REVISION HISTORY					
REV	ECN	DESCRIPTION	SIGN & DATE		
			BY	DATE	AP. DATE
A		Production release	EO	1/31/13	JL 1/31/13

Electrical Specifications				
Item	Unit/Symbol	Condition	Value	Tol.
A _L	nH/N ²	@ 10 KHz	3000	± 20%
L _c	cm	N/A	3.12	± 10%
A _e	cm ²	N/A	0.150	± 10%
V _e	cm ³	N/A	0.47	± 10%
Initial Permeability	μ ₀	@ B < 10 gauss	5000	± 20%
Temp. Coeff. Of initial Permeability	%, °C	20 - 70 °C	0.6	Typ.
Coercive Force	H _c	oersted	0.16	Typ.
Residual Flux Density	Gauss, B _r	N/A	1400	Typ.
Flux Density	Gauss, B	Initial (B), oersted	4300	Typ.
	Gauss, H	@ Field Strength (H), oersted	5	Typ.
Curie temperature	°C	T _c	> 140	Nom.
Resistivity	Ω cm, ρ	@ Field Strength	10 ²	Typ.
Loss Factor	10 ⁻⁶ , tanδ / μ	Initial	15	Typ.
	MHz	@ Frequency	0.1	Typ.

Dimensional Tolerances				
	in	tol.	mm	tol.
Case				
B (Outer Diameter)	0.500	± 0.010	12.70	± 0.25
A (Inner Diameter)	0.312	± 0.008	7.90	± 0.20
H (Height)	0.250	± 0.010	6.35	± 0.25
Weight	2.40 g			

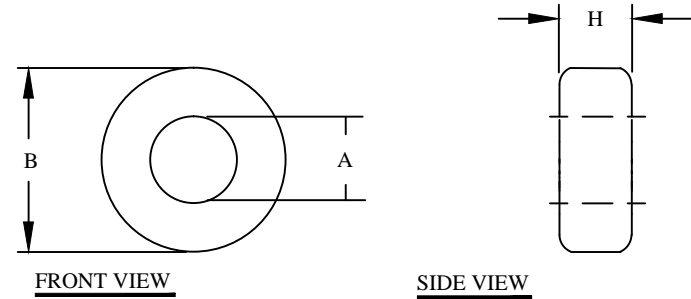

For additional detail, specifications and charts see:

http://www.bytemark.com/products/ferrite_matl.htm

CODE IDENT	MFG. P/N	DESCRIPTION	ITEM NO.
		PARTS LIST	
AUTOCAD	X	www.coilws.com www.cwsbytemark.com	CWSBYTEMARK 353 West Grove Ave. Orange, CA. 92865
SOLIDWORKS			
DRAWN	EO 1/31/13	TITLE: Ferrite Toroid Core Material 75, MnZn	
CHECKED	JL 1/31/13		
ENGR.	JL 1/31/13		
APPR.	JL 1/31/13	SIZE DWG. NO.	REV
		B F-50A-75	A
UNLESS OTHERWISE SPECIFIED		SCALE	SHEET 1 OF 1
DIMENSIONING AND TOLERANCE PER ANSI Y14.5M ALL DIMENSIONS ARE IN INCHES AND [MILLIMETERS]. TOLERANCE INCHES: .XXX=±.005 .XX=±.015 $\sphericalangle=±0°30'$ TOLERANCE METRICS: .XXX=±.127 .XX=±.38 $\sphericalangle=±0°30'$		N/A	
ANGLE PROJECTION			
DO NOT SCALE DRAWING			