

The information contained in this drawing is the sole property of Coil Winding Specialist Inc (CWS). Any reproduction in part or whole without written permission of CWS is prohibited.

## CN80-50-20G

### Features

- High Permeability (30-80K), high impedance Z and high insertion attenuation
- Suppresses the asymmetrical EMI currents
- High saturation Flux density can reduce over voltage peaks
- High Curie Temperature and excellent temperature characteristics

Electrical Specifications				
Item	Units	Condition	Value	Tol.
A <sub>L</sub>	nH/N <sup>2</sup>	@ 1kHz, 200mV	111100	± 25%
A <sub>L</sub>	nH/N <sup>2</sup>	@ 10kHz	72000	± 25%
A <sub>L</sub>	nH/N <sup>2</sup>	@ 100kHz	18000	± 25%
Permeability	μ <sub>0</sub>	@ 10 kHz	50000	± 25%
A <sub>e</sub>	cm <sup>2</sup>	N/A	3.00	± 10%
L <sub>e</sub>	cm	N/A	20.4	± 10%
Saturation Current	mA	@ 10 kHz	50	± 20
Saturation Flux Density	T	N/A	1.2	Max.
Curie temperature	°C	N/A	580	Nom.

Dimensional Tolerances				
	in	tol.	mm	tol.
Core				
B (Outer Diameter)	3.15	±0.40	80	±1
H (Height)	0.79	±0.40	20	±1
A (Inner Diameter)	1.97	±0.40	50	±1
Case				
B (Outer Diameter)	3.39	±0.40	86	±1
H (Height)	1.01	±0.40	26	±1
A (Inner Diameter)	1.76	±0.40	45	±1
Weight	342.00 g			

REVISION HISTORY					
REV	ECN	DESCRIPTION	SIGN & DATE		
			BY	DATE	AP. DATE
A		Production release	EO	1/21/13	JL 1/21/13

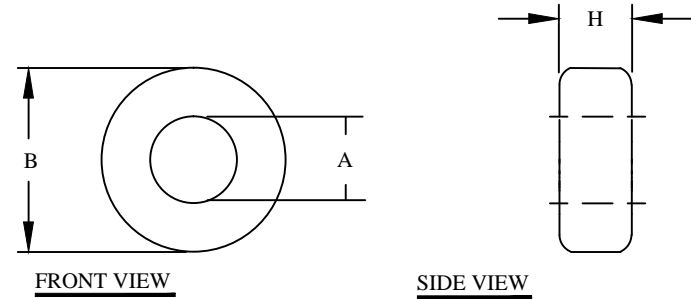

**For additional detail, specifications and charts see:**

[http://www.bytemark.com/products/comp\\_nanoc\\_cmchoke.html](http://www.bytemark.com/products/comp_nanoc_cmchoke.html)

[http://www.bytemark.com/products/Nanocrystalline\\_cores.html](http://www.bytemark.com/products/Nanocrystalline_cores.html)

CODE IDENT	MFG. P/N	DESCRIPTION	ITEM NO.
		<b>PARTS LIST</b>	
AUTOCAD	X	<b>www.coilws.com</b> www.cwsbytemark.com	CWSBYTEMARK 353 West Grove Ave. Orange, CA. 92865
SOLIDWORKS			
DRAWN	EO 1/21/13	<b>Nanocrystalline Core</b>	
CHECKED	JL 1/21/13		
ENGR.	JL 1/21/13		
APPR.	JL 1/21/13	SIZE DWG. NO.	REV
		<b>B</b>	<b>A</b>
		SCALE	SHEET 1 OF 1
		N/A	

UNLESS OTHERWISE SPECIFIED  
 DIMENSIONING AND TOLERANCE PER ANSI Y14.5M  
 ALL DIMENSIONS ARE IN INCHES AND [MILLIMETERS].  
 TOLERANCE INCHES:  
 .XXX=±.005 .XX=±.015 <math>\sphericalangle=±0°30'</math>  
 TOLERANCE METRICS:  
 .XXX=±.127 .XX=±.38 <math>\sphericalangle=±0°30'</math>  
 ANGLE PROJECTION   
 DO NOT SCALE DRAWING