

The information contained in this drawing is the sole property of Coil Winding Specialist Inc (CWS). Any reproduction in part or whole without written permission of CWS is prohibited.

## CN65-50-25G

### Features

- High Permeability (30-80K), high impedance Z and high insertion attenuation
- Suppresses the asymmetrical EMI currents
- High saturation Flux density can reduce over voltage peaks
- High Curie Temperature and excellent temperature characteristics

Electrical Specifications				
Item	Units	Condition	Value	Tol.
A <sub>L</sub>	nH/N <sup>2</sup>	@ 1kHz, 200mV	94320	± 25%
A <sub>L</sub>	nH/N <sup>2</sup>	@ 10kHz	83160	± 25%
A <sub>L</sub>	nH/N <sup>2</sup>	@ 100kHz	15960	± 25%
Permeability	μ <sub>0</sub>	@ 10 kHz	40000	± 25%
A <sub>e</sub>	cm <sup>2</sup>	N/A	1.88	± 10%
L <sub>e</sub>	cm	N/A	18.1	± 10%
Saturation Current	mA	@ 10 kHz	45	± 20
Saturation Flux Density	T	N/A	1.2	Max.
Curie temperature	°C	N/A	580	Nom.

Dimensional Tolerances				
	in	tol.	mm	tol.
Core				
B (Outer Diameter)	2.56	±0.40	65	±1
H (Height)	0.98	±0.40	25	±1
A (Inner Diameter)	1.97	±0.40	50	±1
Case				
B (Outer Diameter)	2.73	±0.40	69	±1
H (Height)	1.13	±0.40	29	±1
A (Inner Diameter)	1.79	±0.40	45	±1
Weight	190.00 g			

REVISION HISTORY					
REV	ECN	DESCRIPTION	SIGN & DATE		
			BY	DATE	AP. DATE
A		Production release	EO	1/21/13	JL 1/21/13

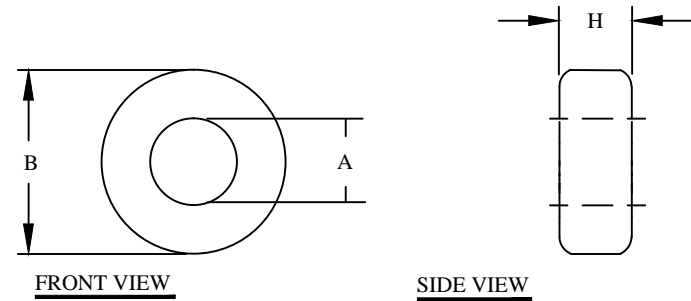

**For additional detail, specifications and charts see:**  
[http://www.bytemark.com/products/comp\\_nanoc\\_cmchoke.html](http://www.bytemark.com/products/comp_nanoc_cmchoke.html)  
[http://www.bytemark.com/products/Nanocrystalline\\_cores.html](http://www.bytemark.com/products/Nanocrystalline_cores.html)

CODE IDENT	MFG. P/N	DESCRIPTION	ITEM NO.
		<b>PARTS LIST</b>	
AUTOCAD	X	<b>www.coilws.com</b> www.cwsbytemark.com	CWSBYTEMARK 353 West Grove Ave. Orange, CA. 92865
SOLIDWORKS			
DRAWN	EO 1/21/13	TITLE: <b>Nanocrystalline Core</b>	
CHECKED	JL 1/21/13	SIZE	DWG. NO.
ENGR.	JL 1/21/13	<b>B</b>	<b>CN65-50-25G</b>
APPR.	JL 1/21/13	SCALE	<b>N/A</b>
UNLESS OTHERWISE SPECIFIED		REV <b>A</b>	
DIMENSIONING AND TOLERANCE PER ANSI Y14.5M		SHEET 1 OF 1	
ALL DIMENSIONS ARE IN INCHES AND [MILLIMETERS].		CAD-FILE:	
TOLERANCE INCHES: .XXX=±.005 .XX=±.015 <math>\angle=±0°30'</math>			
TOLERANCE METRICS: .XXX=±.127 .XX=±.38 <math>\angle=±0°30'</math>			
ANGLE PROJECTION			
DO NOT SCALE DRAWING			