

The information contained in this drawing is the sole property of Coil Winding Specialist Inc (CWS). Any reproduction in part or whole without written permission of CWS is prohibited.

CN40-32-15G

Features

- High Permeability (30-80K), high impedance Z and high insertion attenuation
- Suppresses the asymmetrical EMI currents
- High saturation Flux density can reduce over voltage peaks
- High Curie Temperature and excellent temperature characteristics

| Electrical Specifications | | | | |
|---------------------------|-------------------|---------------|-------|-------|
| Item | Units | Condition | Value | Tol. |
| A _L | nH/N ² | @ 1kHz, 200mV | 58000 | ± 25% |
| A _L | nH/N ² | @ 10kHz | 51880 | ± 25% |
| A _L | nH/N ² | @ 100kHz | 8430 | ± 25% |
| Permeability | μ ₀ | @ 10 kHz | 70000 | ± 25% |
| A _e | cm ² | N/A | 0.60 | ± 10% |
| L _e | cm | N/A | 11.3 | ± 10% |
| Saturation Current | mA | @ 10 kHz | 30 | ± 20 |
| Saturation Flux Density | T | N/A | 1.2 | Max. |
| Curie temperature | °C | N/A | 580 | Nom. |

| Dimensional Tolerances | | | | |
|------------------------|---------|-------|----|------|
| | in | tol. | mm | tol. |
| Core | | | | |
| B (Outer Diameter) | 1.57 | ±0.40 | 40 | ±1 |
| H (Height) | 0.59 | ±0.40 | 15 | ±1 |
| A (Inner Diameter) | 1.26 | ±0.40 | 32 | ±1 |
| Case | | | | |
| B (Outer Diameter) | 1.70 | ±0.40 | 43 | ±1 |
| H (Height) | 0.73 | ±0.40 | 19 | ±1 |
| A (Inner Diameter) | 1.13 | ±0.40 | 29 | ±1 |
| Weight | 37.90 g | | | |

| REVISION HISTORY | | | | | |
|------------------|-----|--------------------|-------------|---------|------------|
| REV | ECN | DESCRIPTION | SIGN & DATE | | |
| | | | BY | DATE | AP. DATE |
| A | | Production release | EO | 1/21/13 | JL 1/21/13 |
| | | | | | |

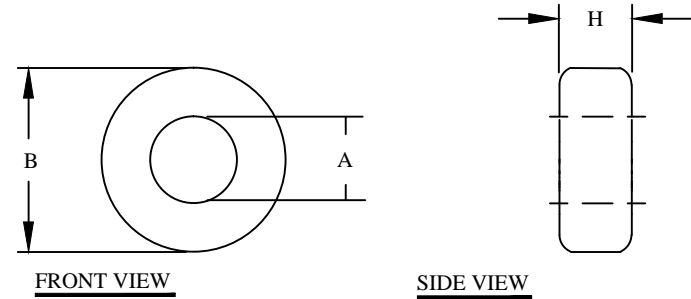

For additional detail, specifications and charts see:

http://www.bytemark.com/products/comp_nanoc_cmchoke.html

http://www.bytemark.com/products/Nanocrystalline_cores.html

| CODE IDENT | MFG. P/N | DESCRIPTION | ITEM NO. |
|---|------------|---|---|
| | | PARTS LIST | |
| AUTOCAD | X | www.coilws.com www.cwsbytemark.com | CWSBYTEMARK 353 West Grove Ave. Orange, CA. 92865 |
| SOLIDWORKS | | | |
| DRAWN | EO 1/21/13 | Nanocrystalline Core TITLE: CN40-32-15G SIZE DWG. NO. B SCALE N/A | |
| CHECKED | JL 1/21/13 | | |
| ENGR. | JL 1/21/13 | | |
| APPR. | JL 1/21/13 | REV | A |
| UNLESS OTHERWISE SPECIFIED | | SHEET 1 OF 1 | |
| DIMENSIONING AND TOLERANCE PER ANSI Y14.5M ALL DIMENSIONS ARE IN INCHES AND [MILLIMETERS]. TOLERANCE INCHES: .XXX=±.005 .XX=±.015 $\angle=±0°30'$ TOLERANCE METRICS: .XXX=±.127 .XX=±.38 $\angle=±0°30'$ | | CAD-FILE: | |
| ANGLE PROJECTION | | DO NOT SCALE DRAWING | |