

The information contained in this drawing is the sole property of Coil Winding Specialist Inc (CWS). Any reproduction in part or whole without written permission of CWS is prohibited.

CN32-20-15G

Features

- High Permeability (30-80K), high impedance Z and high insertion attenuation
- Suppresses the asymmetrical EMI currents
- High saturation Flux density can reduce over voltage peaks
- High Curie Temperature and excellent temperature characteristics

Electrical Specifications				
Item	Units	Condition	Value	Tol.
A _L	nH/N ²	@ 1kHz, 200mV	82950	± 25%
A _L	nH/N ²	@ 10kHz	67880	± 25%
A _L	nH/N ²	@ 100kHz	21360	± 25%
Permeability	μ ₀	@ 10 kHz	46000	± 25%
A _e	cm ²	N/A	0.90	± 10%
L _e	cm	N/A	8.2	± 10%
Saturation Current	mA	@ 10 kHz	20	± 20
Saturation Flux Density	T	N/A	1.2	Max.
Curie temperature	°C	N/A	580	Nom.

Dimensional Tolerances				
	in	tol.	mm	tol.
Core				
B (Outer Diameter)	1.26	±0.40	32	±1
H (Height)	0.59	±0.40	15	±1
A (Inner Diameter)	0.79	±0.40	20	±1
Case				
B (Outer Diameter)	1.36	±0.40	35	±1
H (Height)	0.73	±0.40	19	±1
A (Inner Diameter)	0.70	±0.40	18	±1
Weight	44.00 g			

REVISION HISTORY					
REV	ECN	DESCRIPTION	SIGN & DATE		
			BY	DATE	AP. DATE
A		Production release	EO	1/21/13	JL 1/21/13

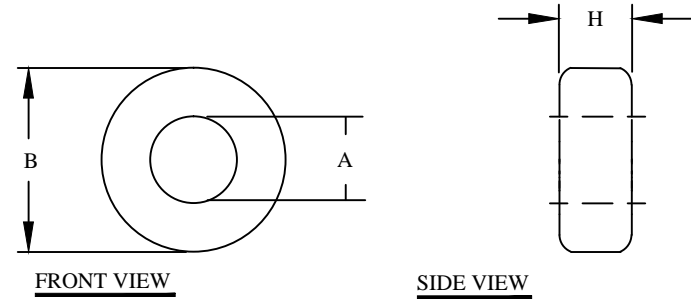

For additional detail, specifications and charts see:

http://www.bytemark.com/products/comp_nanoc_cmchoke.html

http://www.bytemark.com/products/Nanocrystalline_cores.html

CODE IDENT	MFG. P/N	DESCRIPTION	ITEM NO.
		PARTS LIST	
AUTOCAD	X	www.coilws.com www.cwsbytemark.com	CWSBYTEMARK 353 West Grove Ave. Orange, CA. 92865
SOLIDWORKS			
DRAWN	EO 1/21/13	Nanocrystalline Core	
CHECKED	JL 1/21/13		
ENGR.	JL 1/21/13		
APPR.	JL 1/21/13	SIZE DWG. NO.	REV
		B	A
		SCALE	SHEET 1 OF 1
		N/A	

UNLESS OTHERWISE SPECIFIED
 DIMENSIONING AND TOLERANCE PER ANSI Y14.5M
 ALL DIMENSIONS ARE IN INCHES AND [MILLIMETERS].
 TOLERANCE INCHES:
 .XXX=±.005 .XX=±.015 $\sphericalangle=±0°30'$
 TOLERANCE METRICS:
 .XXX=±.127 .XX=±.38 $\sphericalangle=±0°30'$
 ANGLE PROJECTION
 DO NOT SCALE DRAWING