

The information contained in this drawing is the sole property of Coil Winding Specialist Inc (CWS). Any reproduction in part or whole without written permission of CWS is prohibited.

REVISION HISTORY						
REV	ECN	DESCRIPTION	BY	DATE	CHK	DATE
A		INITIAL RELEASE	JL	02/21/17	JM	02/21/17

Features

- High Permeability (30-80k), high Impedance Z and high Insertion attenuation
- Suppresses the asymmetrical EMI currents
- High saturation Flux density can reduce over voltage peaks
- High Curie Temperature and excellent temperature characteristics
- Core Type: Nanocrystalline, NanoByte™

Electrical Specifications				
Item	Units	Condition	Value	Tol.
A_L	$\mu\text{H}/\text{N}^2$	@ 10KHz	15.8 - 31.5	N/A
A_L	$\mu\text{H}/\text{N}^2$	@ 100KHz	7.9	N/A
Permeability @ H peak 3.14 mA/cm	μ_0	@ 10KHz	30000	±25%
A_e	cm^2	N/A	5.20	±10%
L_e	cm	N/A	87.10	±10%
$L_e \times N$	mA x turn	@ 10KHz	185	±10%
$L_e \times N$	mA x turn	@ 100KHz	185	±10%
Saturation Flux Density	T	N/A	1.2	Max.
Curie Temperature	°C	N/A	580	Nom.

Dimensions and Tolerances				
	in	tol.	mm	tol.
Core Only				
B (Outer Diameter)	11.81	±0.40	300	±1
A (Inner Diameter)	9.84	±0.40	250	±1
H (Height)	1.18	±0.40	30	±1
With Case On				
B (Outer Diameter 1)	15.43	±0.40	392.0	±1
C (Outer Diameter 2)	6.30	±0.40	160.0	±1
A (Inner Diameter 1)	12.83	±0.40	326.0	±1
D (Inner Diameter 2)	3.70	±0.40	94.0	±1
H (Height)	1.46	±0.40	37.0	±1

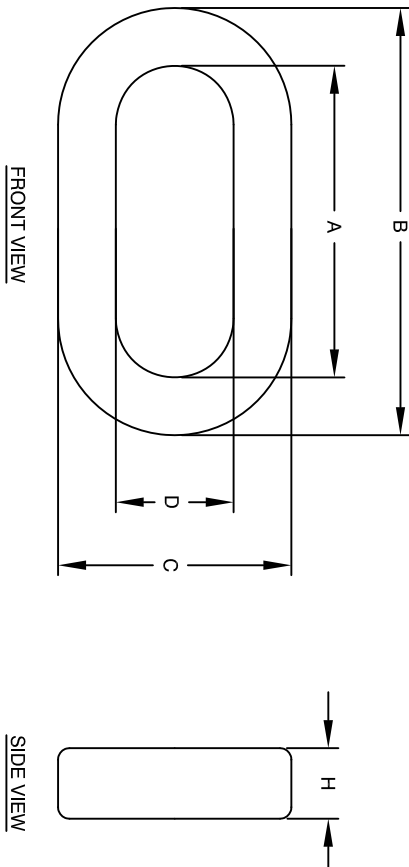

CODE	MFG. P/N	DESCRIPTION	ITEM NO.
IDENT			

AUTOCAD		SOLIDWORKS	
DATE	DATE	DATE	DATE
02/21/17	02/21/17	02/21/17	02/21/17

ENGR.	CHKD	APP.	SCALE	SIZE	DATE	REV
JM	JM	JM	N/A	1/4"	02/21/17	A

PARTS LIST	
DESCRIPTION	QTY
Nanocrystalline Core	1

UNLESS OTHERWISE SPECIFIED	
DIMENSIONING AND TOLERANCE PER ANSI Y14.5M	
ALL DIMENSIONS ARE IN INCHES AND (MILLIMETERS)	
TOLERANCE RANGES: .XX±.005 .XX±.015 .XX±.025 .XX±.038	
TOLERANCE METRICS: .XX±.127 .XX±.38	
ANGLE PROJECTION:	
DO NOT SCALE DRAWING	